

1 2 3 4 5 6 7

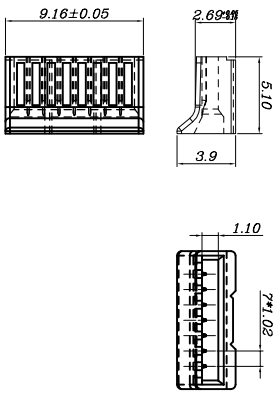

SPECIFICATIONS
1. ELECTRICAL:
 UL APPLICATIONS: 250 VOLTS AC MAX., AT 2 AMPS
 DIELECTRIC WITHSTANDING VOLTAGE: 1000 VOLTS AC
 WITHSTAND VOLTAGE TIME: 60S
 INSULATION RESISTANCE: 100M Ω
 TERMINATION RESISTANCE: 20M Ω MAX AFTER
 2. MECHANICAL: ENVIRONMENTAL TESTING
 CABLE TO PLUG TENSILE STRENGTH: 19.6N/PCS MIN.
 DURABILITY: 200 MATING CYCLES
 3. MATERIAL & FINISH
 HOUSING: POLYCARBONATE UL94V-0 OR UL94V-2
 COLOR: TRANSPARENT OR OTHER COLOR ARE AVAILABLE.
 CONTACT BLADE: COPPER ALLOY.
 CONDUCTOR: STRANDED & SOLID WIRE, 24AWG, 26 AWG.
 GOLD PLATING: 50μ"

BLADE:	Z
Drawing	
Mark	

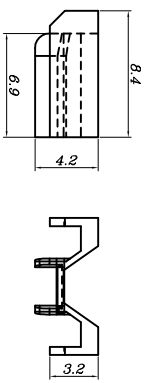
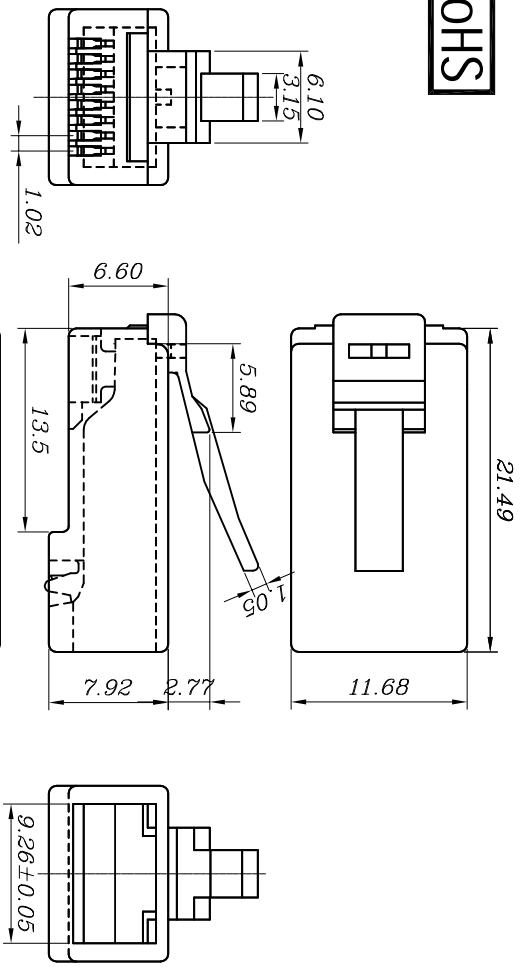
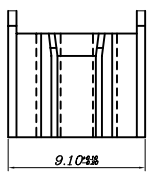

		Quest Technology International, Inc. 11200 NW 138th St. Medley, FL 33178	
DIMENSION IN mm (Inch)	TOLERANCE UNLESS OTHERWISE SPECIFIED	MATERIAL	图号
.XX±0.10	.XX±2°	PC	NMP-8925
X±0.20	X°±5°	名称	MOD PLUG W/LOAD BAR, CAT6A RJ45, 8P8C, RND.
审核	核对	TITLE	SOLID/STRD. 50U, UL
APPORVAL	CHECKED	制图	比例
		CathyLi	2/1
			张数
			1/1
			修改
			A

1 2 3 4 5 6 ST-DR-009A 7

REV	DATE	变更内容	修改
	2013/09/05		DRAWN